

**Witney Local Centre & School House Type Schedule**

House type	Bedrooms	No.	Sqft
<b>Private</b>			
X204 HOLLY	2 BED HOUSE	5	851
X305 HAZEL	3 BED HOUSE	16	932
X307 SPRUCE INFORMAL	3 BED HOUSE	2	1079
X308 CYPRESS	3 BED HOUSE	5	1107
X413 CHESTNUT	4 BED HOUSE	4	1360
X414 ASPEN INFORMAL	4 BED HOUSE	8	1370
X418 MULBERRY	4 BED HOUSE	4	1600
<b>Total Private</b>		<b>44</b>	
<b>Affordable Rented</b>			
X204 HOLLY	2 BED HOUSE	7	851
2B WC	2 BED HOUSE	4	1065
S325 APPLE	2 BED HOUSE	6	1007
S426 PEAR	2 BED HOUSE	2	1143
<b>Affordable First Homes</b>			
SF131	1 BED APARTMENT	8	
<b>Affordable Shared Ownership</b>			
X204 HOLLY	2 BED HOUSE	1	851
S325 APPLE	2 BED HOUSE	2	1007
<b>Total Affordable</b>		<b>30</b>	
<b>TOTAL</b>		<b>74</b>	

**LEGEND**

- Site Boundary
- 1.8m High Close Board Fence
- 1.8m High Screen Wall
- 1.8m High Panel Fence
- - - - - 1m High Estate Railings
- - - - - 1m High Hoop Top Railings
- 1.5m High Close Board Fence with 300mm Trellis
- 2.1m High Screen Wall
- 300mm Timber Knee Rail
- Hedgehog Highways (1No. 13 x 13cm hole at base of 1No. fence panel in run, sign to be attached above hole.)
- Social Rented
- Shared Ownership
- First Homes
- Cycle Sheds required to accommodate the following -  
 2 Bed House - 4 Cycles ■  
 3 Bed House - 6 Cycles ■  
 4 Bed House - 8 Cycles ▲  
 Sheds to be located as indicated
- V Visitor Parking Space
- ▲ Electric Vehicle Charging Point - Mode 3
- Bollard - Marshall's Rhino RT Key Op Fold Down Bollard Colour Black
- Chimney
- Part M4(2) Compliant Plot
- Part M4(3) Compliant Plot
- Part M4(3) Compliant Parking
- - - - - 4 No. Cycle Hoops
- Timber Framed Plots

- A: Red line site boundary revised. Service Access Zone shown. 26.01.24 ZT
- B: Template for plot 13 moved forwards against the side of plot 13's parking. 13.05.24 ZT
- C: Part M4(2) Compliant plot symbol shown on plots 36, 37 and 45. 22.05.24 ZT
- D: EV point added to the rear fence of plot 74. 28.05.24 ZT
- E: Mulberry and Cypress handings corrected. 05.06.24 RW

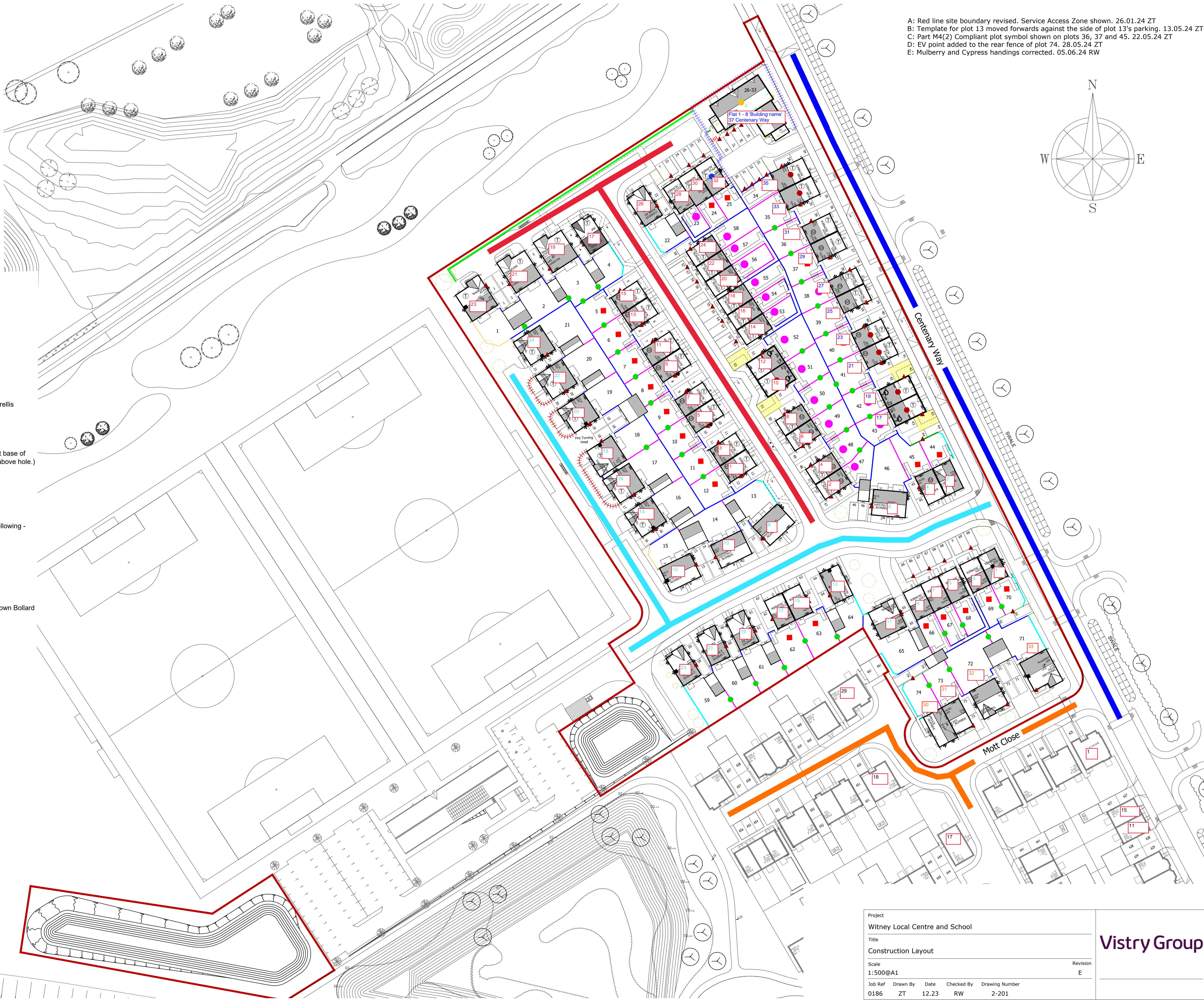
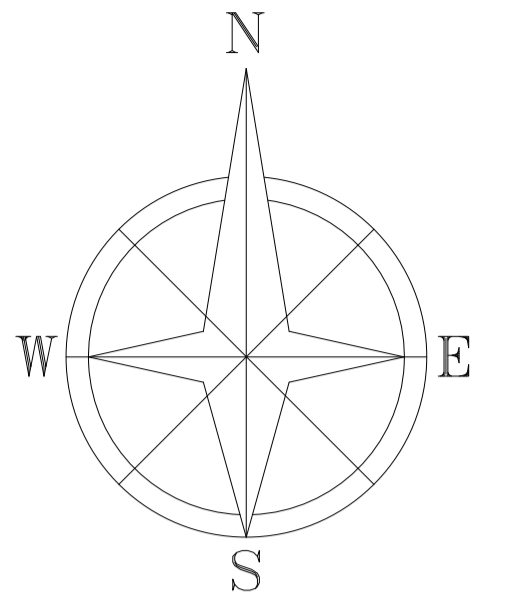

POST AND RAIL FENCE TO TIE INTO EXISTING

Project		Witney Local Centre and School	
Title		Construction Layout	
Scale	1:500@A1	Revision	E
Job Ref	0186	Drawn By	ZT
Date	12.23	Checked By	RW
Drawing Number	2-201		

Vistry Group